

Download and Install Family Atlas for Mac

This Magic Guide covers:

- A. Finding the Family Atlas Installer on RootsMagic.com
- B. Downloading with Safari
- C. Downloading with Google Chrome
- D. Installing Family Atlas
- E. Adding the Family Atlas shortcut icon to your Dock
- F. Registering Your Software



NOTE: The first few steps of this handout apply to any web browser you use. Likewise, the installation process is identical no matter which web browser you used to download the software. It is only after you click the option to download the Family Atlas (FA) installer, that the web browser takes over and the processes varies from browser to browser. Therefore, there will only be one set of instructions for finding the installer and for installing the program. Separate download instructions will be provided for Safari and Google Chrome.

A. Finding the Family Atlas Installer on RootsMagic.com

1. Open the web browser of your choice and go to

<http://rootsmagic.com/download/>.

2. Find the Family Atlas download link.

3. Click "Download".



4. The “Download Family Atlas window will open.



5. Click on the link to start the download.

This ends the instructions for finding the installer. You may proceed to the download instructions for the browser of your choice.

B. Downloading with Safari



1. After clicking on the “Family Atlas for Mac Installer” link, the download process indicator will appear in the upper right corner of the screen.

2. Once the download process is finished, the icon will change to a gray circle with a white arrow pointing down.

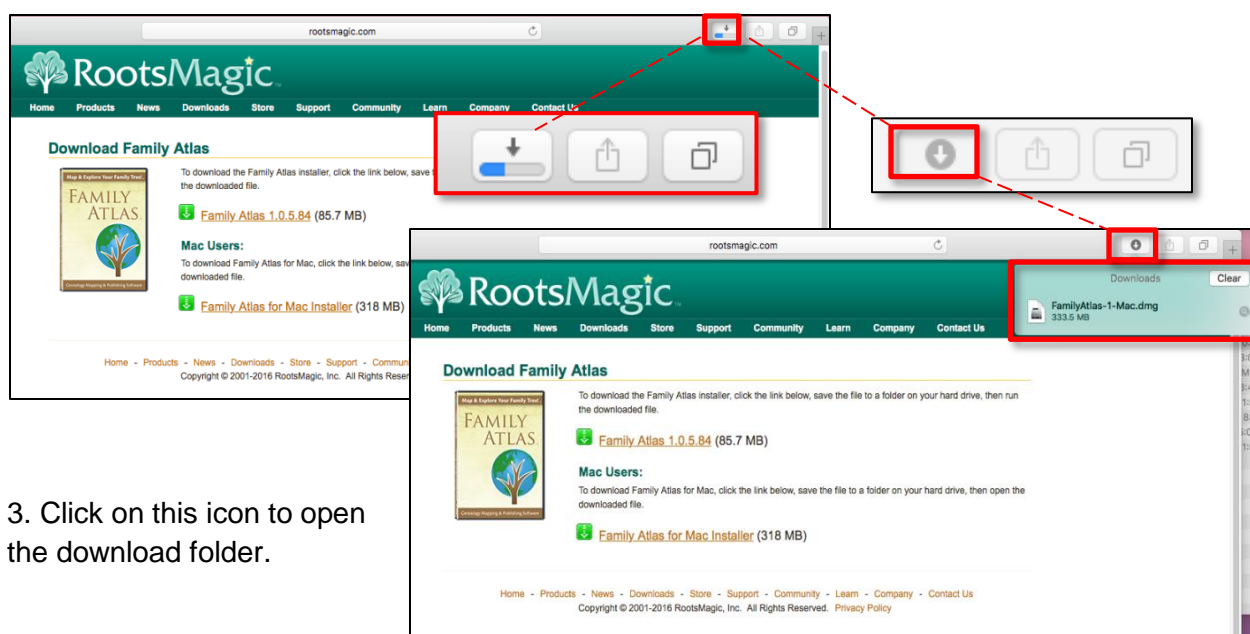

3. Click on this icon to open the download folder.

4. Double Click the “FamilyAtlas-1-Mac.dmg” file from the download folder.

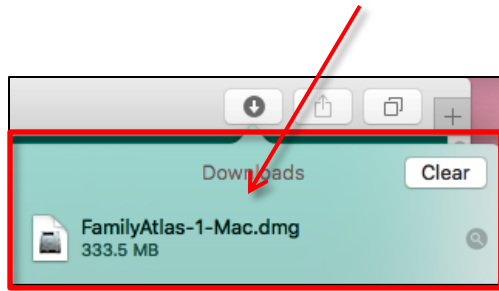

5. This screen will open, and then close automatically when it completes its process.

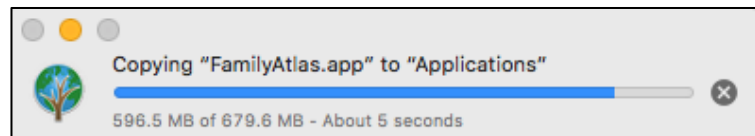

This ends the instruction for downloading with Safari. You may proceed to section D.

C. Downloading with Google Chrome (Chrome)



1. After clicking on the “Family Atlas for Mac Installer” link, you will see the download progress indicator in the lower left corner of your computer screen.

2. When the download is complete, click on the FamilyAtlas-1-Mag.dmg.



D. Installing Family Atlas

If you see a message that says, “Image not recognized” or “The document ‘FamilyAtlas-1-Mac.dmg’ could not be opened. Disk Utility cannot open files in the ‘Disk Image’ format”. Click OK to close that message. Proceed to step 1. Otherwise, proceed to Step 4.

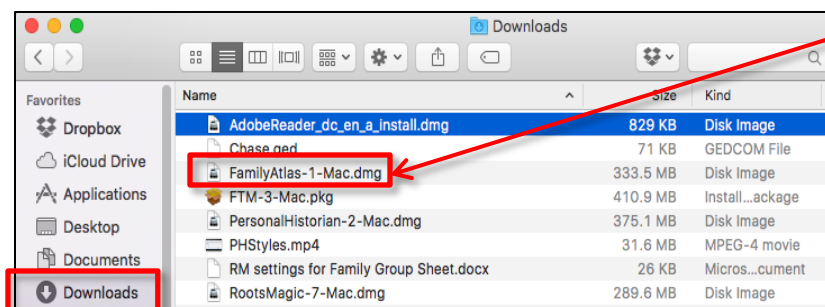

1. Right click (or Ctrl+Click) on the RootsMagic-7-Mac.dmg file on the desktop or in File>Downloads.



2. A new window will open. Click on “Get Info”.

3. Find the “Open with” heading and choose “DiskImageMounter.app”.

4. When the Family Atlas Applications screen opens, drag and drop the Family Atlas icon over to the blue “Applications” folder within this window.

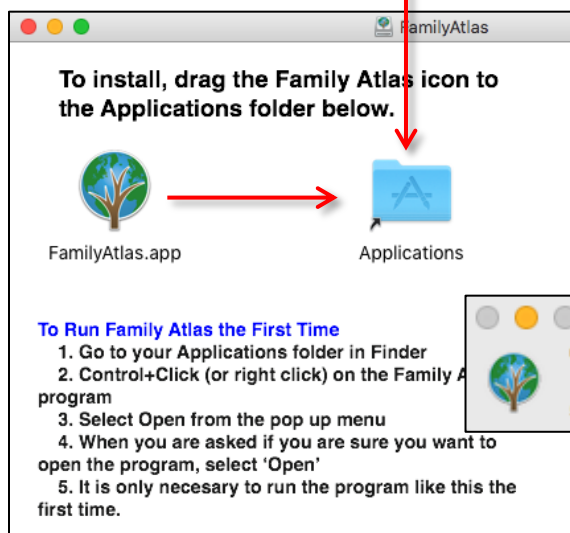
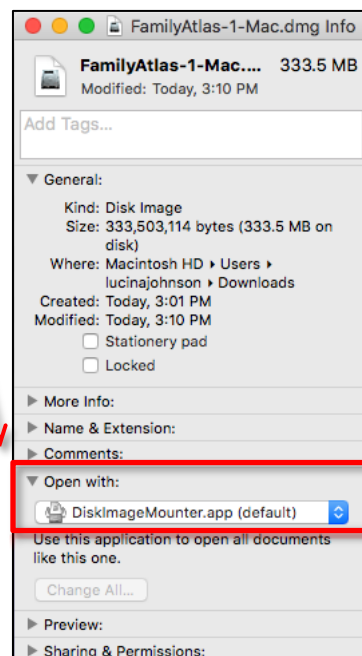

5. This will copy the Family Atlas app to the Applications folder.

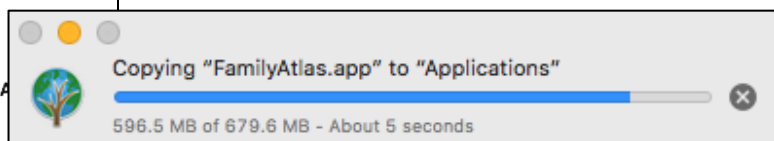

6. If you receive a message that says, "Family Atlas cannot be opened because the program's identity cannot be confirmed", do the

following to change your preferences.

- a. Click the black Apple icon in the upper left corner of your desktop, select System Preferences> Security and Privacy> General Tab > Unlock (click the lock to make changes).
- b. Login with your Apple password.
- c. Under "Allow apps to download from:", select the option "Anywhere".
- d. Click the lock again to lock this window.

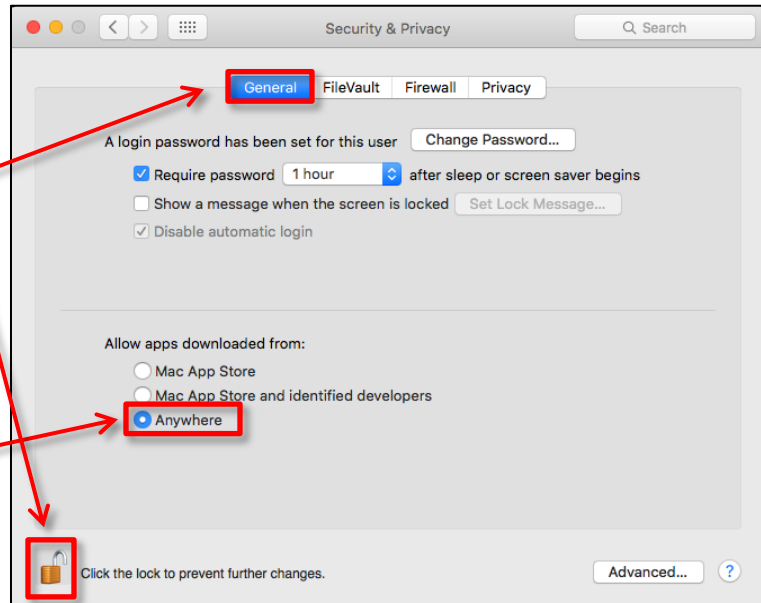

7. Drag and drop the Family Atlas icon over to the blue "Applications" folder again. (Screenshot by Step 4 Section D)

8. To see the application, click on "Finder" on your Dock.



9. Open your "Applications list" by selecting "Applications" from the left panel of the "Finder" screen.

10. The **first** time you open FA, you will need to Control+Click (or right click) on the Family Atlas app

11. Select Open from the pop up menu.

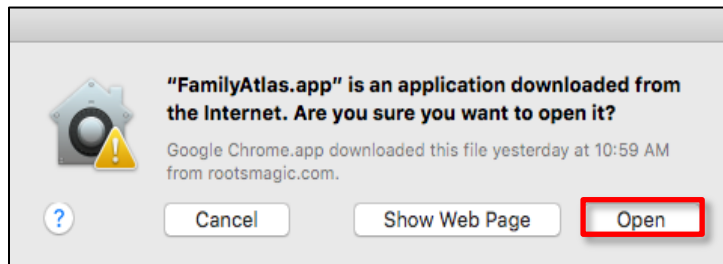
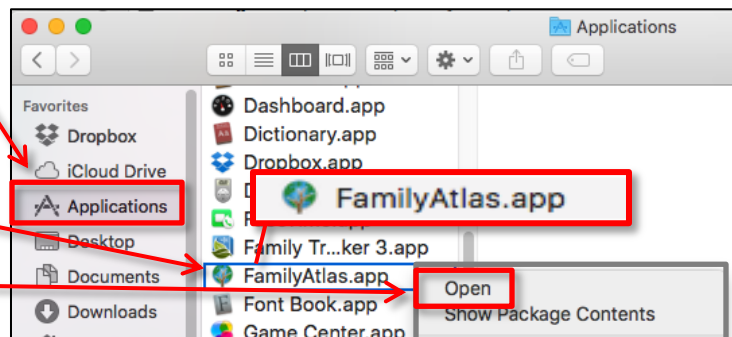

12. If you see a warning like this, click Open.

13. It is only necessary to run the program like this the first time. After that, you can open the application by double clicking on the Family Atlas

application or by clicking on the Family Atlas icon on your Dock.

E. Adding the Family Atlas shortcut icon to your Dock

1. Open your Finder window.

2. Select “Applications” from the left panel.

3. Find “Family Atlas” on the “Applications list”.

4. Click on Family Atlas, hold the mouse button down, drag icon to your Dock and release the click.

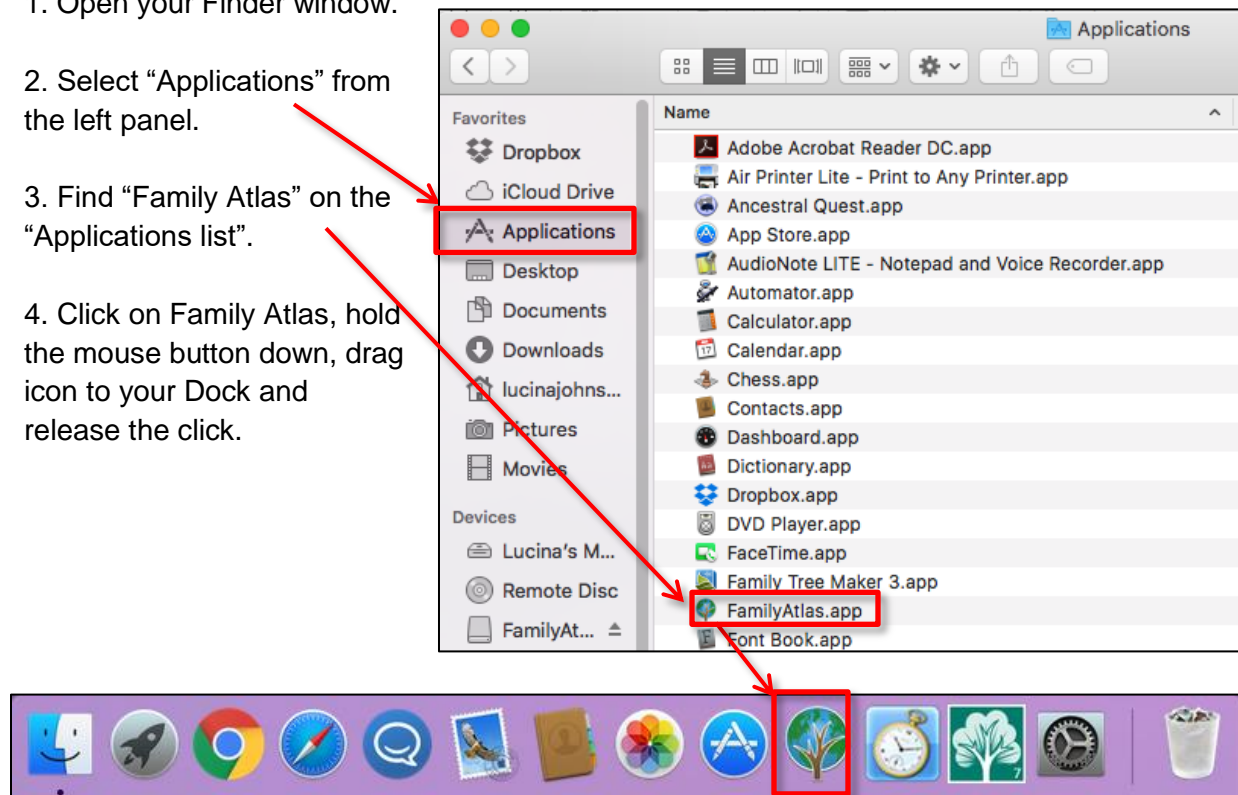

5. Once the Family Atlas icon is on your dock, click on the icon to open Family Atlas.

F. Registering Your Software



1. The registration window will open. Click Next.

2. Enter your name and your registration key.

A screenshot of the "Family Atlas Registration" dialog box. The title bar says "Family Atlas Registration". The main text asks "What is your registration key?". Below this, it explains that the key is found in the CD case or via email. It also provides contact information for support. There are two input fields: "Your Name:" and "Registration Key:". The "Registration Key:" field contains the placeholder text "XXXX-XXXX-XXXX". At the bottom right, there are three buttons: "< Back", "Next >", and "Cancel". The "Next >" button is highlighted with a red rectangle.

3. Once you enter your registration key, the "Next" button will become active. Click "Next".

A screenshot of the "Family Atlas Registration" dialog box. The title bar says "Family Atlas Registration". The main text asks "Would you like to register over the Internet?". Below this, it explains that by registering, you will be informed of new updates, features, and upgrades. There are two radio buttons: "Yes, register my copy via the Internet" (which is selected and circled in red) and "No, do not register at this time". At the bottom right, there are three buttons: "< Back", "Next >", and "Cancel". The "Next >" button is highlighted with a red rectangle.

4. After unlocking the program, you will be given the option to register your copy of Family Atlas. Click Next to continue.

5. Click Finish to complete the installation.

A screenshot of the "Family Atlas Registration" dialog box. The title bar says "Family Atlas Registration". The main text says "Thank you for purchasing Family Atlas. Your software is now registered and ready for use." It also provides contact information for support. At the bottom right, there are three buttons: "< Back", "Finish", and "Cancel". The "Finish" button is highlighted with a red rectangle.

6. If you do not register at the time of installation, you can register later by going to our website. Hover your cursor

over the “Support” tab and click “Register Your Software”.

7. Change the product name to Family Atlas and fill in the form.

8. Click “Register” when done.

9. Should you ever need to retrieve your license key, go to <http://rootsmagic.com/Recover-Key/>, or hover your cursor over the “Support” tab and click “Request a Lost Product Key”.

The screenshot shows the RootsMagic website's 'Register Your Software' page. The navigation bar includes 'Home', 'Products', 'News', 'Downloads', 'Store', 'Support', 'Community', and 'Learn'. The 'Support' dropdown menu is open, showing 'Get Help', 'Register Your Software', and 'Request a Lost Product Key'. The 'Register Your Software' form includes fields for Product (set to 'Family Atlas'), Registration Key, First Name, Last Name, E-mail, Verify E-mail, Address, City, State/Province, ZIP/Postal Code, Country (set to 'United States'), and Phone. A 'Register' button is at the bottom right of the form.

Your key will be emailed to the address on your registration.



Note: RootsMagic respects your right to privacy. We will never spam you or sell your personal information to a third party. To learn more, please read our [Privacy Statement](#).